

690



Admissible under Rule 21 of the Bengal Tenancy Act/ Non-Agricultural Tenancy Act - duly stamped (or exempt from or does not require stamp duty) under the Indian stamp Act, 1899, Schedule I. A. No. Fee Paid.....

Handwritten notes on the left margin including '23', '21(1)', '43-50', and '43-50'.

Madhale Chandra

SUB REGISTRAR

Cassioora Dum Dum 34-1-6

Main body of handwritten text in Bengali script, including names like 'দীনক কুমার' and 'স্বদেশ কুমার'.

Lower section of handwritten text in Bengali script, starting with 'কুমার-প্রদত্ত'.

No. 153
 Sold to Mr. Dr. D. Park Kumar Roy
 37, Belgachia Road
 Calcutta 37
 for Rs. 100/-
 Date 12/1/62 Stamp Clk.
 24-Parganas, Treasury: Alipor.



Produced for Registration on
 12-1-62 at 12:30 P.M. on the 30th
 day of Jan 1962 at the
 Consular Dum Dum Sub-Registry
 Office by Madhab Chandra Kunder
 Executant one of the Executors
 Claimant one of the Claimants
 Attorney for
 Executant of Claimant under a
 Power of Attorney No. _____
 at 18 _____
 authenticated by the

SUB-REGISTRAR
 Consipore, Dum Dum

30-1-62

Madhab Chandra Kunder

Madhab Chandra Kunder

P. I. DISPENSED WITH

Rupees ten thousand

as consideration is paid in
 my presence by Bipak

Kumar Roy to Madhab Chandra Kunder

Jarit Bhattacharya

Produced for Registration on
 12-1-62 at 12:30 P.M. on the 30th
 day of Jan 1962 at the
 Consular Dum Dum Sub-Registry
 Office by Madhab Chandra Kunder
 Executant one of the Executors
 Claimant one of the Claimants
 Attorney for
 Executant of Claimant under a
 Power of Attorney No. _____
 at 18 _____
 authenticated by the

Produced for Registration on
 12-1-62 at 12:30 P.M. on the 30th
 day of Jan 1962 at the
 Consular Dum Dum Sub-Registry
 Office by Madhab Chandra Kunder
 Executant one of the Executors
 Claimant one of the Claimants
 Attorney for
 Executant of Claimant under a
 Power of Attorney No. _____
 at 18 _____
 authenticated by the

SUB-REGISTRAR
 Consipore, Dum Dum

30-1-62



[Signature]
AD REGISTRAR
Companies, Dum Dum.

30-1-6

Handwritten text at the top right edge of the page.



Handwritten scribble above the typed text.
Compro, Dum Dum.

30-1.6





6
Compro, Dum Dum

30-1-62

San - Indira Gandhi

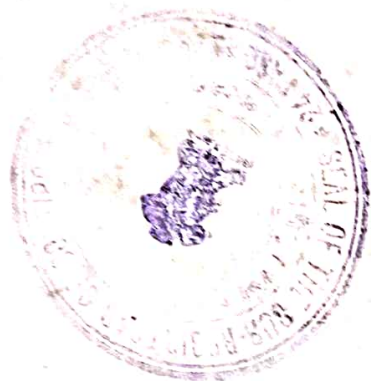

[Handwritten signature]

COSSIPORE, Dum Dum

30-1-6



SUB REGISTRAR
Coosipore, Dam Dam

30-1-62

C.B. BLOT NO. 1255
MITEA



[Signature]
SUB-DIVISIONAL
Officer, Dum Dum
30-1-62
N. S. 6

SUB-DIVISIONAL
Officer, Dum Dum
2-2-62

[Signature]

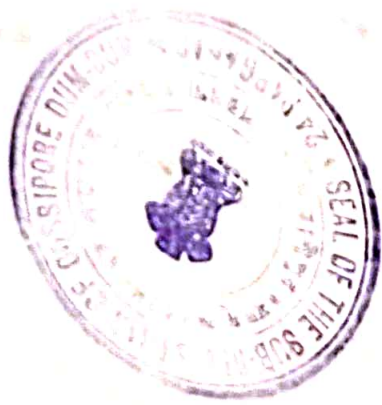

[Signature]
Book No. _____
Volume No. _____
Pages _____ to _____
being No. _____
for the year 19____

MOUZA=DAKHINDARI.J.L.NO 25.
SCALE = 1-60' feet.

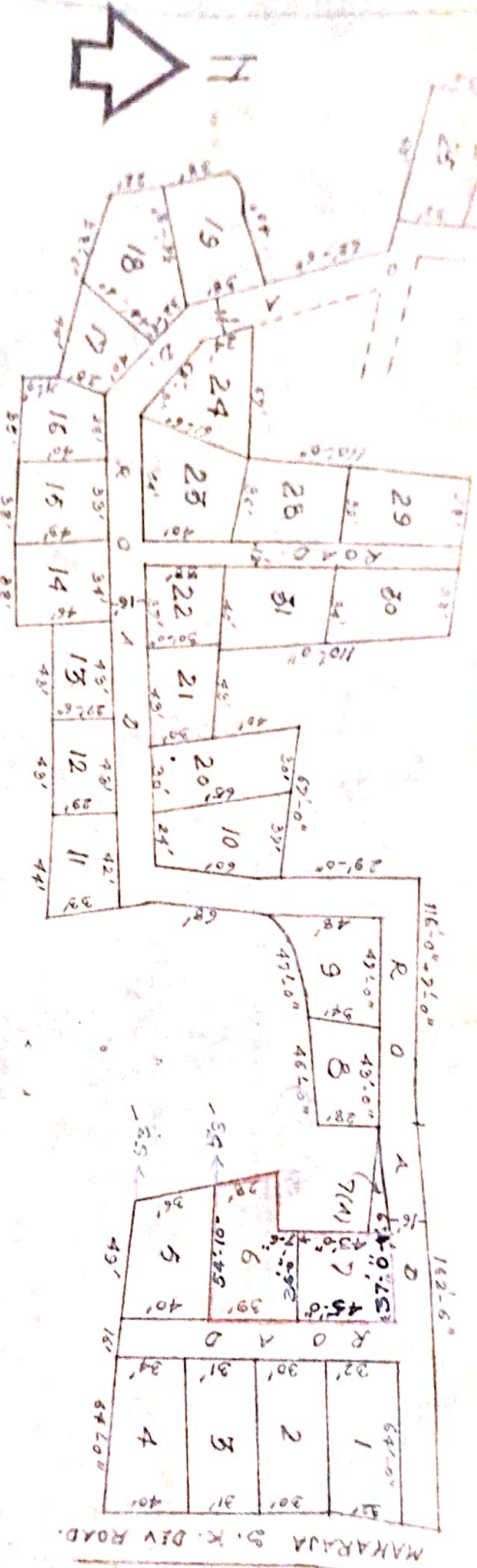

PLT NO.	SQ. FT.	K	CH-SET.	BLT NO	SQ. FT.	K	CH-SET.	PLT NO	SQ. FT.	K	CH-SET.
1	1820	2	18-22	12	1219 1/4	1	11-4 1/4	22	1270	1	12-10
2	1364	2	12-4	14	1602	2	5-27	23	2115	2	15-0
3	2868	3	4-26	15	1473 1/4	2	0-53 1/4	24	3083 1/2	4	4-25 1/2
4	2109	2	14-39	16	1557	2	2-7	25	1978 1/2	2	11-45 1/2
5	2042	2	13-17	17	1438 1/2	1	15-45 1/2	26	1848	2	9-5
6	1608	2	3-31	18	2385	3	4-43	27	3435	4	12-13
7	1379 1/2	1	14-29 1/2	19	1790	2	7-35	28	1870	2	9-25
8	1927	2	10-37	20	2025	2	13-0	29	1650	2	4-30
9	1906 1/4	2	10-16 1/4	21	1290	1	12-30	30	1705	2	5-40
10	1835	1	13-28	21(4)	336	0	7-21	31	2035	2	13-10

ROAD 805' x 16'-0" WIDTH + 150'-0" x 12'-0"

Handwritten signature or name at the bottom left corner.

Plan of dead No. 658
Attended to Page 271
Book No. 1 Vol No. 12
1962

S.P.
2.2.62

[Handwritten signature]
for de 1102

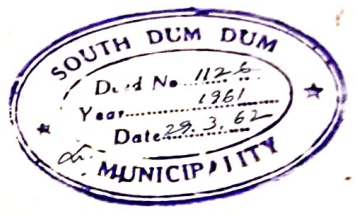
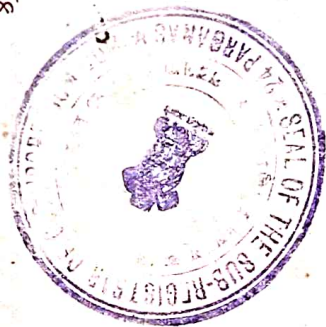

[Handwritten signature]
SUB REGISTRAR
Gaspore, Dum Dum

30-1-62